

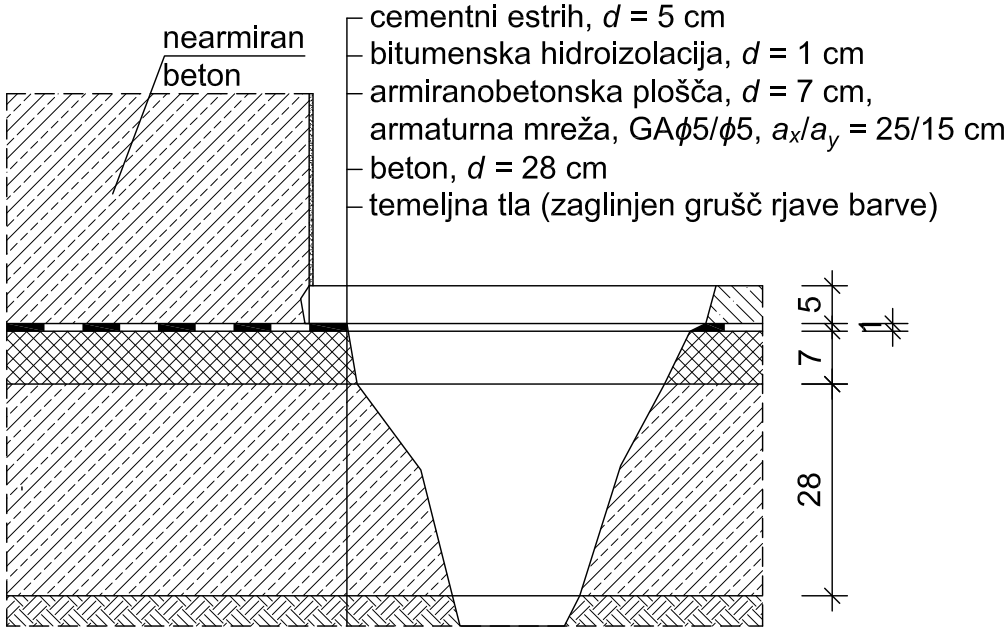



T1 - Sondažni izkop ob temelju - navpični prerez, M 1:10



- Legenda:
-  Ti - mesto sonde: sondažni izkop ob temelju
  -  Si - mesto sonde na stropu ali nosilcu
  -  Zi - mesto sonde na zidu ali stebriu

Z1 - Sonda na zidu

- nearmirani beton (do globine 8 cm ni armature)
- omet,  $d = 0.5$  cm

S1 - Sonda na stropu - navpični prerez, M 1:10

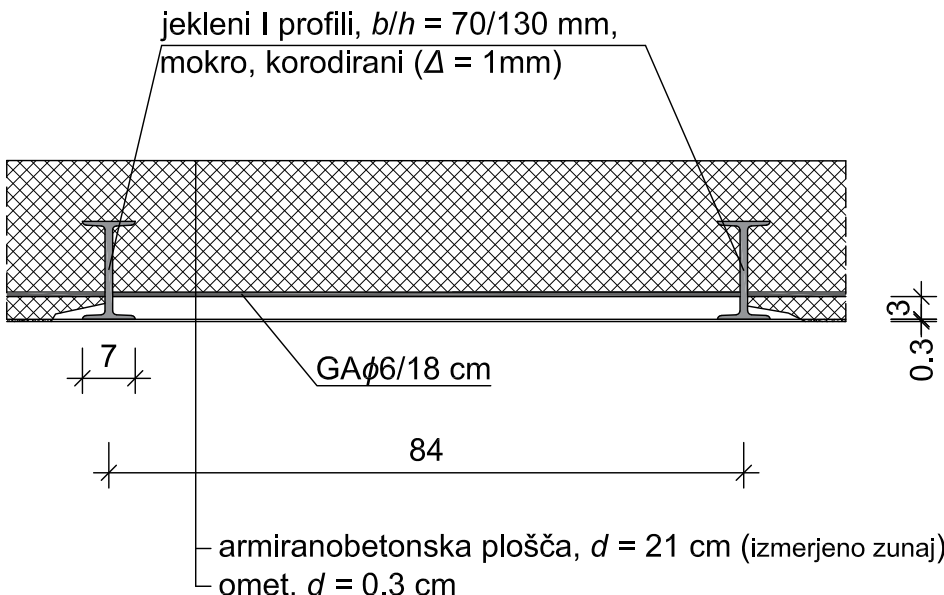

Objekt A - vila, tloris klet

Mesta pregleda objekta in ugotovitve preiskovalnih sond